

Equipment, accessories and disposables

Supplementary equipment:

- TRIOzone 5210, for bowel insufflation of the mixture Oxygen/Ozone

Accessories :

- Custom-made examination mattress (foam 33. FF, thickness 80mm)
- Backsplash (58x58x20)
- Pair of leg-rests (3 positions i.e. 3 heights)

Options :

- Computer connection/link thanks to the patient management software „Séquoia“
- Remote control (only Transflow 416)

Disposables :

- Irrigation kit (cannula, stop valve, irrigation pipe, draining pipe)
- Irrigation pack (50 irrigation kits, 1 liter decontaminating product for device, 2 filters of 1 μ)
- Reduced diameter cannula + stop valve (for children, malformations, surgical history)
- Piping kits, for small diameter cannula
- Lubricant for cannulas (jar of 500ml non-fat)
- Decontaminating product for device (1 liter bottle)
- Water filters, 1 μ for device (pair)

Fit out examples for your irrigation room:

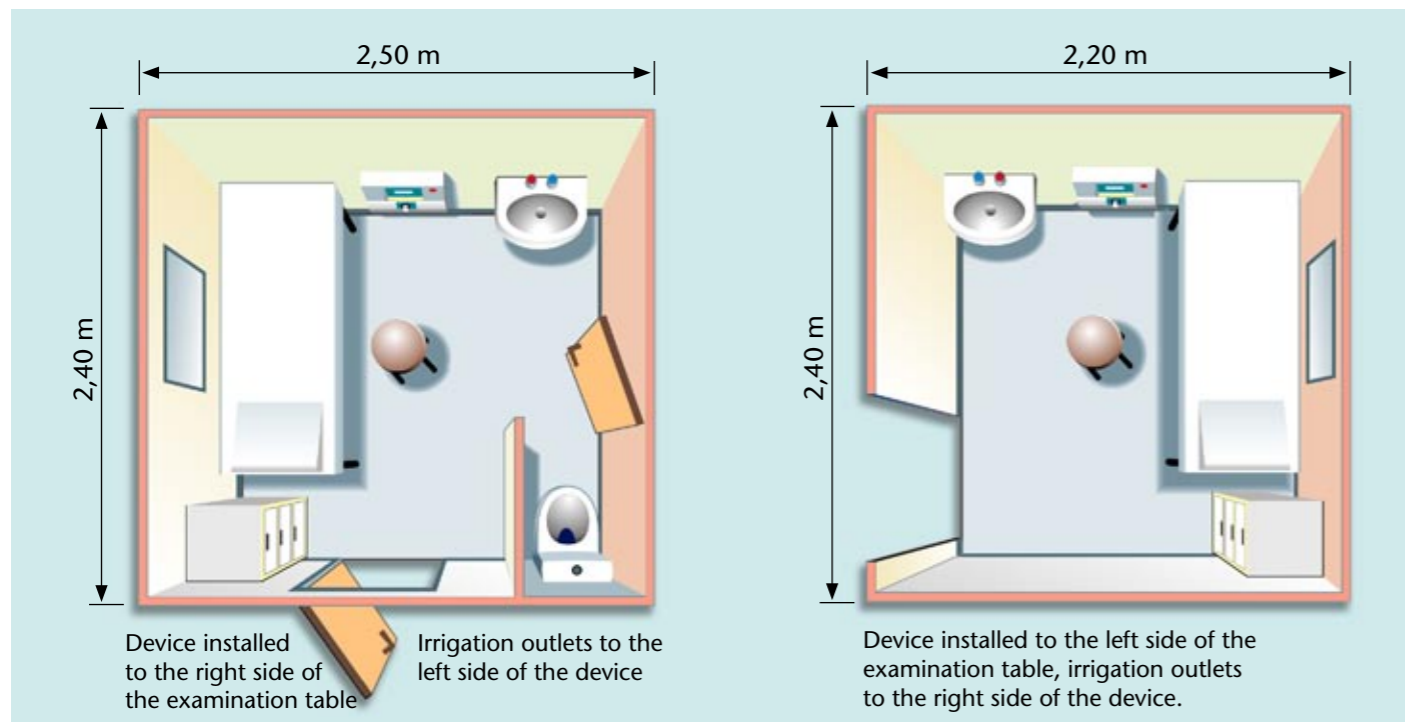

Clem also offers

TRIOzone

Ozonized oxygen
Recovery of vital processes



RHéotome

Medical electronics
Diagnostic aid...
Control and follow-up of prescriptions



Transflow

Bowel hygiene, Colonic irrigation

Filtered fresh water,

Saltwater,

Marine plasma,

Various solutions



Model **416**
remote controlled

Clem
Prevention, solutions

Clem

302 rue de Charenton, 75012 PARIS
– 00 33 (0)1 53 17 68 99 / 00 33 (0)6 26 85 48 36
info@clem-prevention.com – www.clem-prevention.com

Compact device
Easy to install

Ergonomics and safety
Ease of use

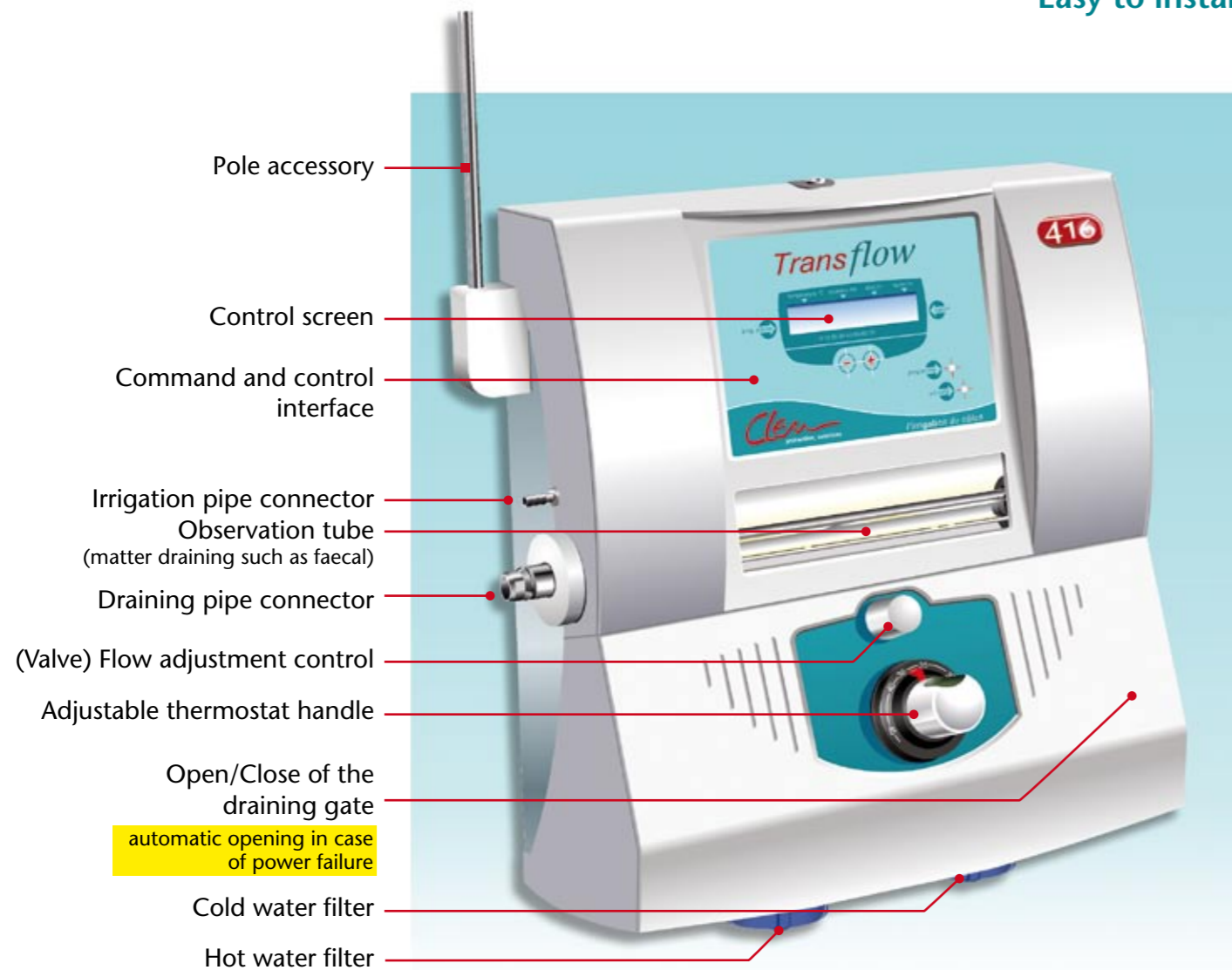

Special features:

- **Manufactured in stainless materials** (stainless steel and synthetic materials)
- **Electricity supply and functioning with low voltage 24 V** (hospital safety rules). Maximum consumption: 60 W
- **Device "to the right" or "to the left"**
 - **Standard** : Irrigation outlets to the left for installation to the right side of the examination table.
 - **Variant**: Irrigation outlets to the right for installation to the left side of the examination table
- **Simple installation and moving possibilities** thanks to the pre-equipped embase, allowing connections of hot water, cold water and draining before the Transflow laying.
- **Integrated solutions module:** Preset solutions for marine plasma dilution and salt water, and/or flows of direct solutions or in %.

Use characteristics:

- **Water supply:**
 - Supply pressure contained between 2.5 and 3.5 bars.
 - Pressure difference between hot and cold water must be less than 0.4 bars.
- **Pipe connection**
 - Copper supply Ø 10/12
 - Draining in pressure resistant PVC DN 25 - Ø 32
- **Hot water preparation:**
 - it is imperative this must be achieved through a storage system:
 - either standard with a minimum capacity of 75 litres, 1500 W minimum (if higher capacity, 2000 W minimum)
 - or through a continuous flow system with a capacity of 15 litres, 2000 W.
- **Avoid "collective" hot water preparation.**
- **Prohibit gas water & bath heaters.**

Technical features

Commands :

- Opening/closing of the evacuation through motorised valve.
- Decontamination simplified by an automatic cycle (human-machine dialogue)
- Of the output accelerator exhaust (high flow or turbo, without disturbing the irrigation flow)

Settings :

- Temperature from 25 to 45°C, with safety lock at 39°C (unlockable)
- Irrigation flow from 6 to 60 liter/hour, through micrometer tap for a precise adjustment.
- Solution parameters

Programming :

- Of the session of 45 min with countdown
- Solution parameters (choice of the solution, dilution or flow of direct various solutions or in %)

Controls :

- Temperature
- Irrigation flow and combined flow (irrigation + solutions)
- Irrigation pressure (in millibars) with double display: digital and bargraph
- Irrigation time (in minutes, digital display)

Securities :

- Temperature, through safety lock by 39°C, on the temperature setting handle.
- Pressure 1, through ultrasensitive manostat, stopping the irrigation and solutions in case of pressure higher than 85mbar.
- Pressure 2, through ultrasensitive manostat, opening the draining gate if pressure exceeds 110mbar.
- Draining gate open automatically in case of power failure.
- Safety valve opening at 125mbar.



Remote control

Control and command interface

